

TRAFFIC SAFETY WAREHOUSE

The Best in Safety for Less

ECONOMY SOLAR POWERED FLASHING LED TRAFFIC SIGNS



Meets MUTCD Standards

Make crosswalks safer, reduce accidents, and save lives!

- Solar powered; no AC power required
- Operates ~70 hours on full charge
- 1/8" (3 mm) aluminum sign panel with 3M DG³ reflective sheeting
 - Anti-graffiti protective overlay
 - UV protective film
 - Stainless-steel fasteners
- 3 Switches for Function Selection:
 1. Flashing or steady light
 2. On all day or turn on at dusk
 3. Auto-Dim mode adjusts to surrounding brightness (lowers light output at night), saving energy
- Visible over 0.62 miles (1000 m), super bright LEDs
 - Flash rate of 55 times per minute; LEDs flash simultaneously
- Fully adjustable solar panel, lock in position at maximum sun angle
- Tamper proof, wiring is built into sign and batteries hidden in pole
- Waterproof level IP65 and maintenance free
- Installs on any 2" - 3" (5 -7.6 cm) round or square sign post (not included)
- Includes installation hardware
- One year manufacturer warranty on parts

Rev. 10/16/2024

ECONOMY SOLAR POWERED FLASHING LED TRAFFIC SIGNS

Solar Panel Angle Adjusts For Maximum Light Exposure

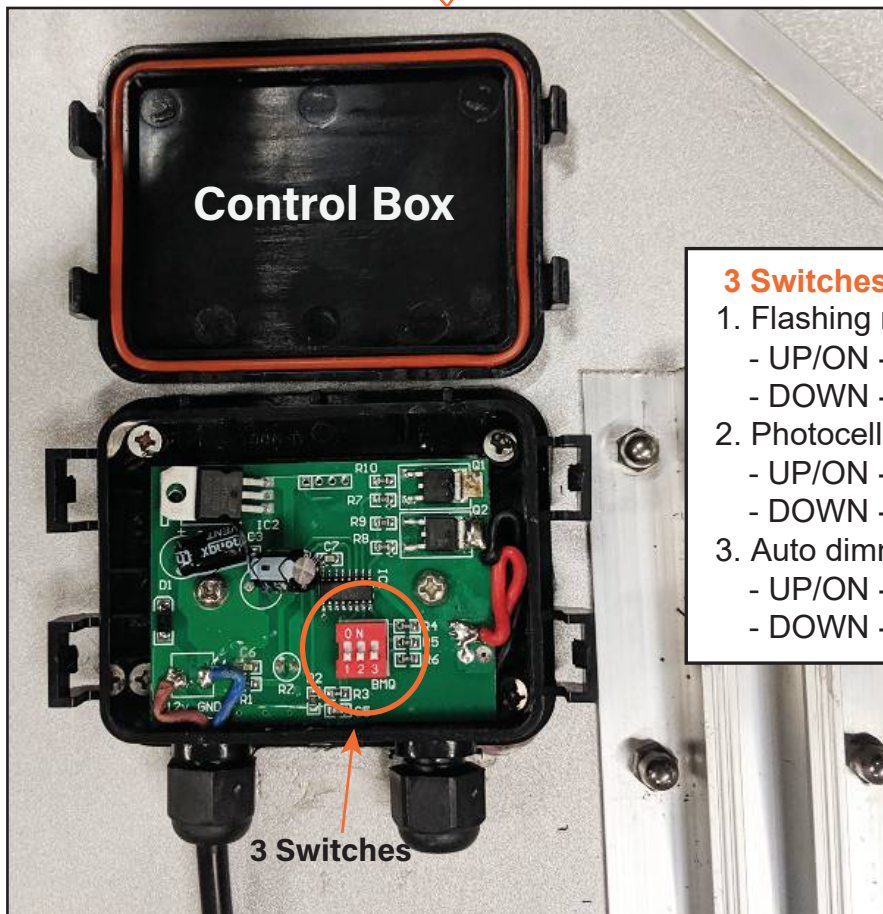
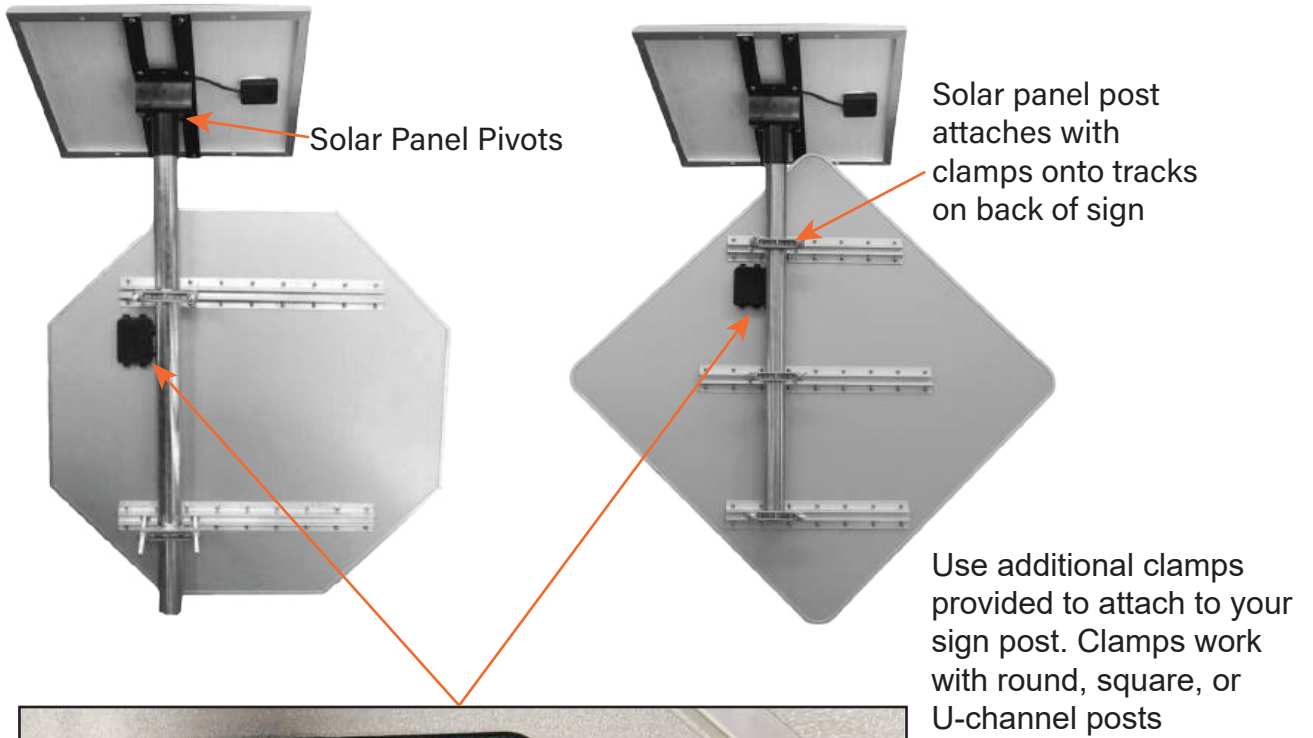

- 3 Switches for Function Selection:**
1. Flashing mode switch
 - UP/ON - steady light
 - DOWN - flashes
 2. Photocell switch
 - UP/ON - auto on at night only
 - DOWN - light always on
 3. Auto dimming switch
 - UP/ON - auto dims at night
 - DOWN - does not auto dim

ECONOMY SOLAR POWERED FLASHING LED TRAFFIC SIGNS

Specifications:

- Visibility: over 0.62 miles (1000 m)
- LED life expectancy: over 100,000 hours
- Solar panel: DC12V 40W monocrystal solar module
- Battery type: 12V 9AH lithium battery pack
- Full charge operation: ~70 hours
- Working temperature: -22°F - 176°F (-30°C to 80°C)
- Waterproof level IP65
- All mounting hardware included to fit round, square, or U-shaped post

Stop Signs - 30 36

MUTCD Code: R1-1 8 White LEDs Sign Color: 3M DG³ red and white

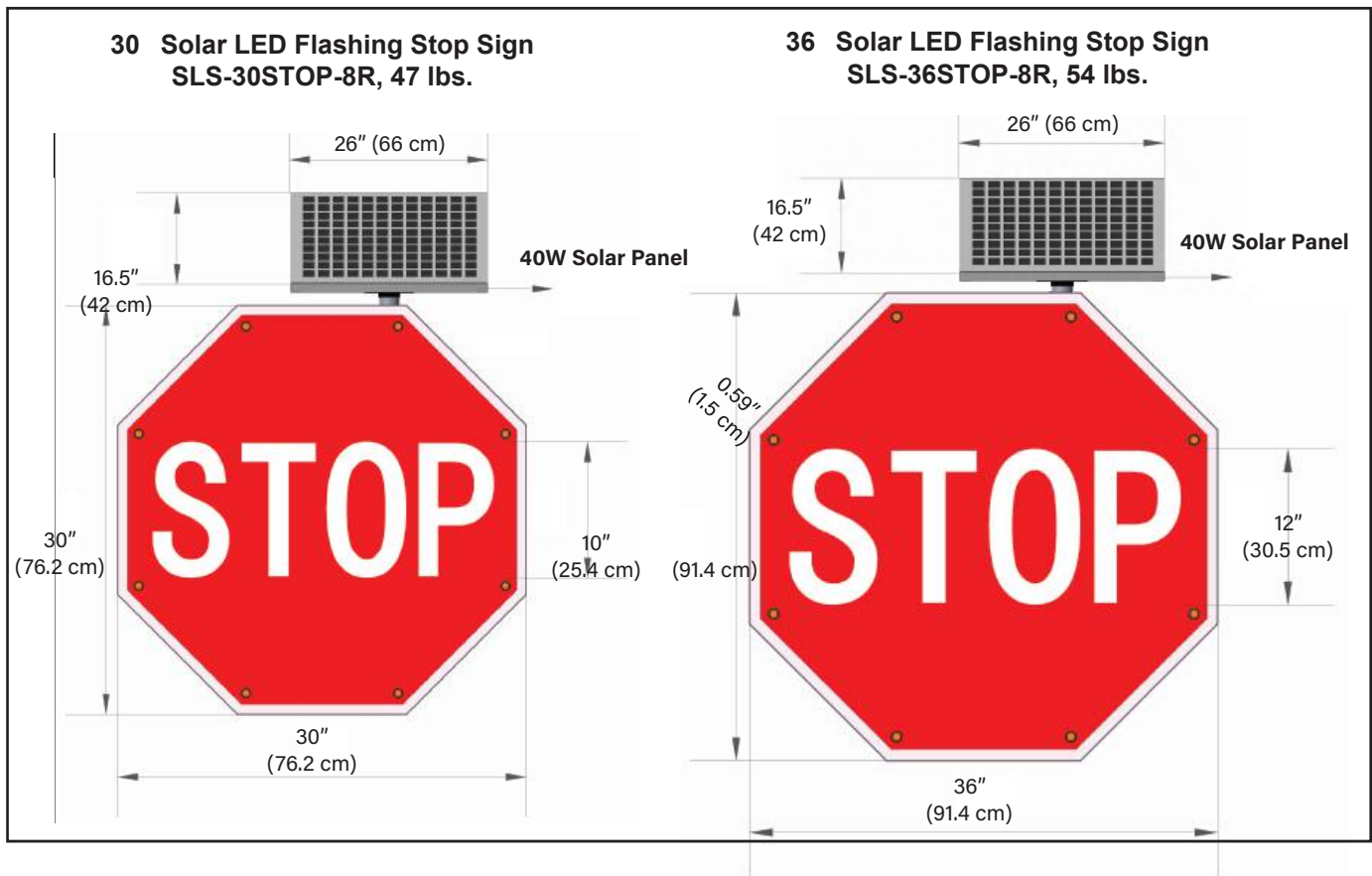

ECONOMY SOLAR POWERED FLASHING LED TRAFFIC SIGNS

Diamond Shaped Signs

Sign Color: 3M DG³ fluorescent yellow green and black
8 Amber LEDs 47 lbs.

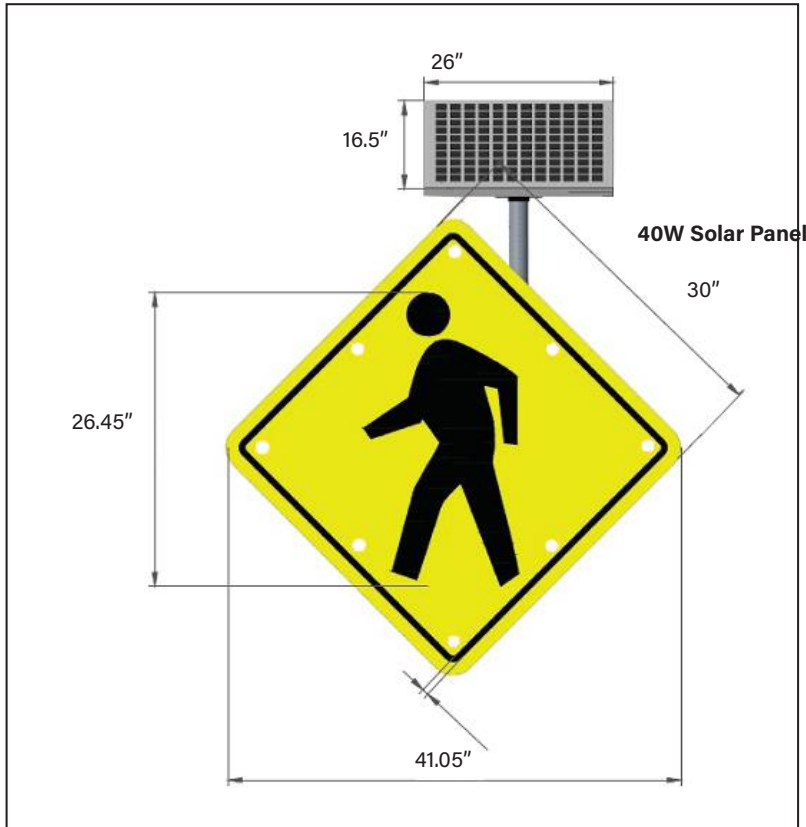

Crossing Sign (shown left)

- SLS-30PED-8A
- MUTCD Code: W11-2



Bicycle Pedestrian Crossing Sign

SLS-30BICPED
MUTCD Code: W11-15