

LED TRAFFIC SIGNS Aluminum Signs With Super Bright Solar Powered LED Lights



Meets MUTCD Standards

Make crosswalks safer, reduce accidents, and save lives!

- › Solar powered, no AC power required, can be connected to AC with DC Converter
- › Double layer aluminum and plastic sign panel with 3M DG³ reflective sheeting
 - anti-graffiti protective overlay
 - stainless steel fasteners
- › 3 Switches for Function Selection:
 1. Flashing or steady light
 2. On all day or turn on at dusk
 3. Auto-Dim mode adjusts to surrounding brightness (lowers light output at night), saves energy
- › Visible over 0.62 miles (1000 m), 8 super bright LEDs per sign
 - flash rate of 50-60 times per minute, LEDs flash simultaneously
- › Fully adjustable solar panel, lock in position at maximum sun angle
- › Tamper proof, wiring is built into sign and batteries hidden in pole
- › 100% waterproof and maintenance free
- › Easy to install on any 2" - 3" (5 -7.6 cm) round or square sign post
- › Includes installation hardware
- › One year manufacturer warranty on parts

LED TRAFFIC SIGNS

Solar Panel Angle Adjusts For Maximum Light Exposure

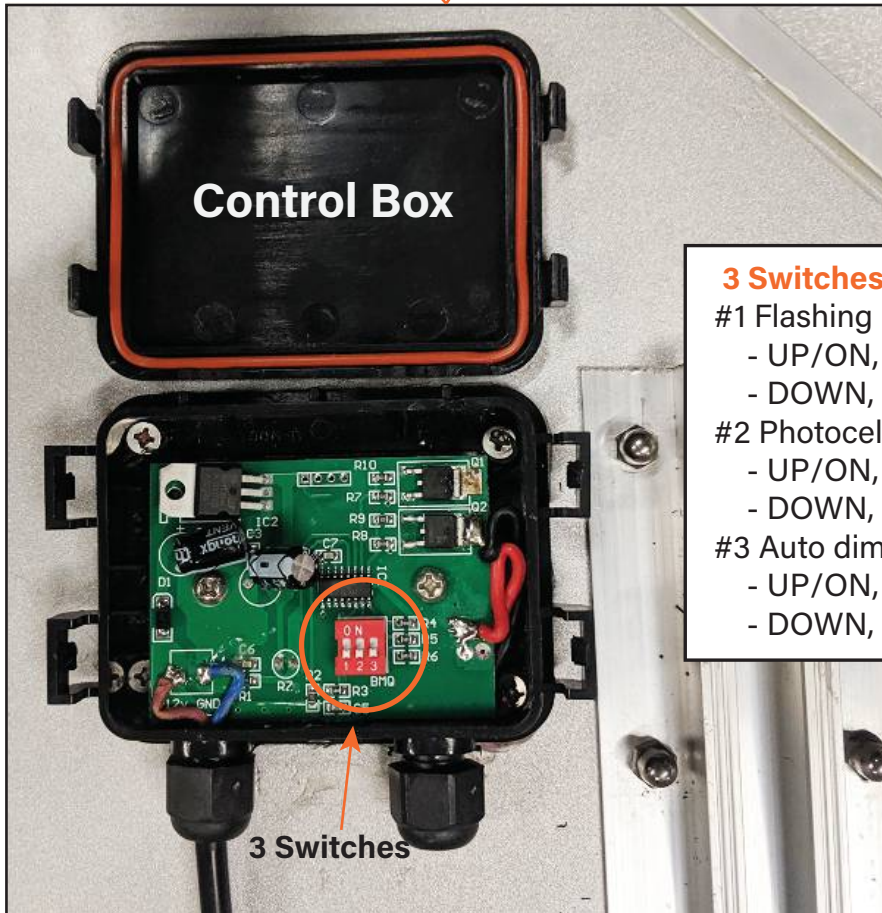
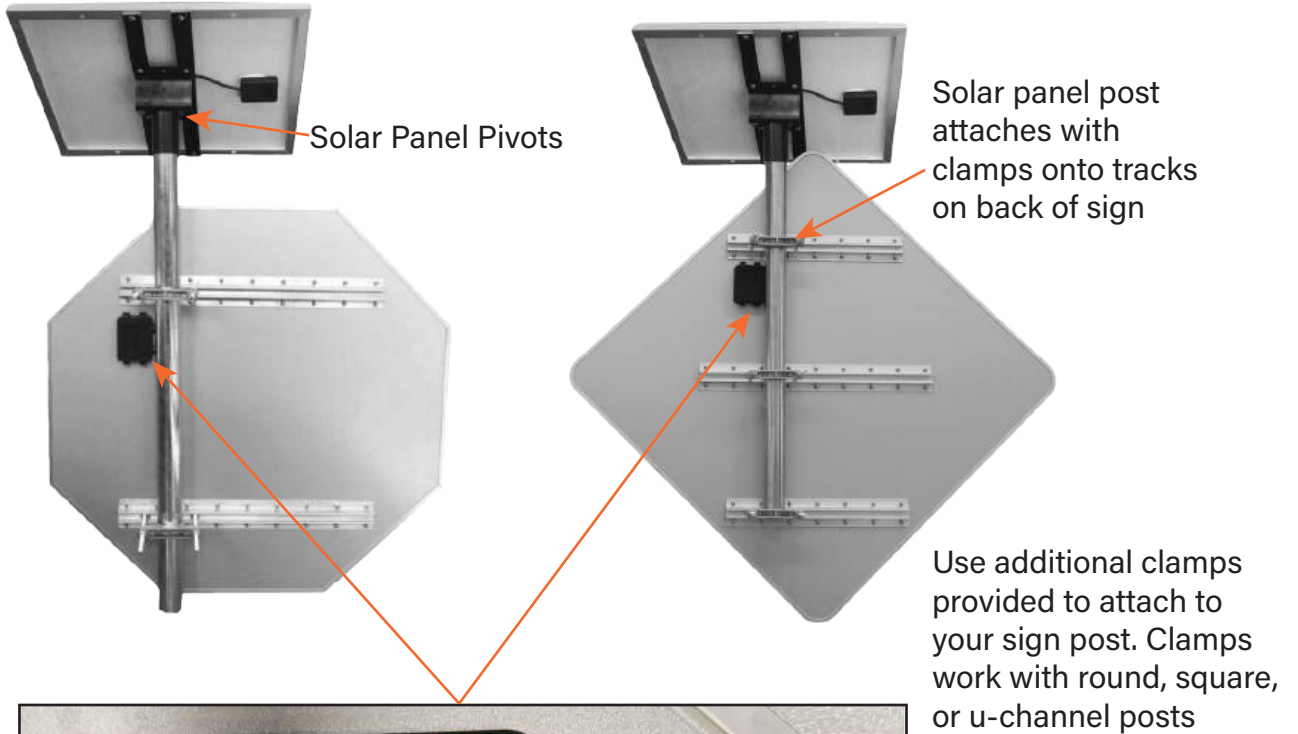

- 3 Switches for Function Selection:**
- #1 Flashing mode switch
 - UP/ON, steady light
 - DOWN, flashes
 - #2 Photocell switch
 - UP/ON, auto turns on night only
 - DOWN, light always on
 - #3 Auto dimming switch
 - UP/ON, auto dims at night
 - DOWN, does not auto dim.



Scan to visit our website for additional information

LED TRAFFIC SIGNS

Stop Sign Specifications

- ▶ MUTCD Code: R1-1
- ▶ LED's: 8, white
- ▶ Sign Color: 3M™ DG3 red and white
- ▶ All mounting hardware included to fit round, square, or u-shaped post
- ▶ Visibility: over 0.62 miles (1000 m)
- ▶ LED Life Expectancy: over 100,000 hours
- ▶ Solar Panel: DC12V 20W monocrystal solar module
- ▶ Battery Type: 12V 9AH lithium battery pack
- ▶ Full charge operation: 70 hours
- ▶ Working Temperature: -4°F - 140°F (-20°C to 60°C)

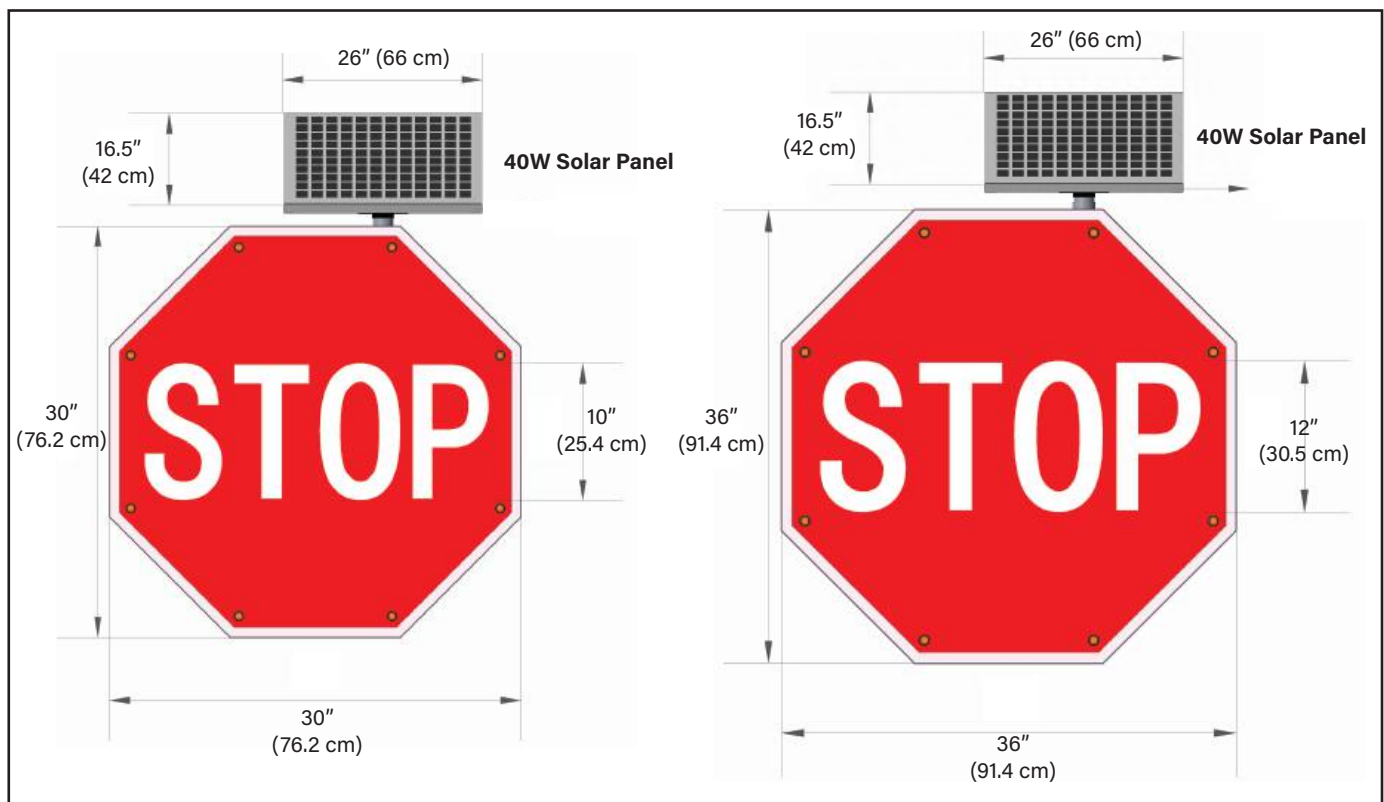

30" Solar LED Flashing Stop Sign
SLS-30STOP-8R
Sign Dimensions
30" x 30" Octagon, 1/2" thick
Weight: 47 lbs. (21.5 kg)

36" Solar LED Flashing Stop Sign
SLS-36STOP-8R
Sign Dimensions
36" x 36" Octagon, 1/2" thick
Weight: 54 lbs. (24.5 kg)

LED TRAFFIC SIGNS

Pedestrian Crossing Sign Specifications

- › MUTCD Code: W11-2
- › LED's: 8, amber
- › Sign Color: 3M™ DG3 fluorescent yellow/green and black
- › Sign Dimensions: 30" x 30" diamond, 1/2" thick
- › Weight: 47 lbs. (21.5 kg)
- › All mounting hardware included to fit round, square, or u-shaped post
- › Visibility: over 0.62 miles (1000 m)
- › LED Life Expectancy: over 100,000 hours
- › Solar Panel: DC12V 20W monocrystal solar module
- › Battery Type: 12V 9AH lithium battery pack
- › Waterproof Level: IP65
- › Full charge operation: 70 hours
- › Working Temperature: -4°F - 140°F (-20°C to 60°C)

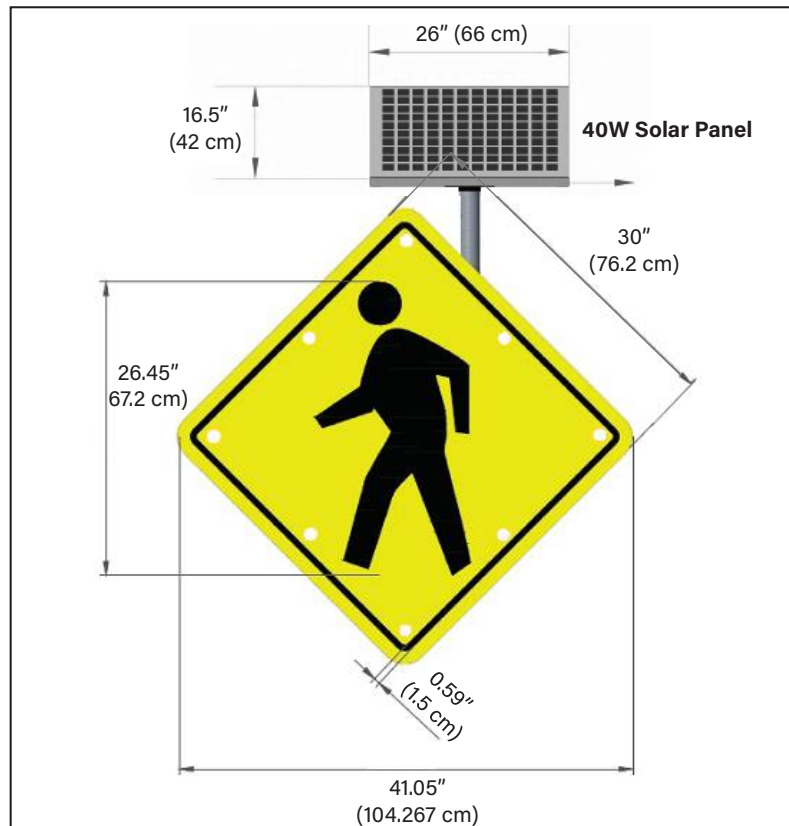

Solar LED Flashing Crossing Sign
SLS-30PED-8A
Sign Dimensions
30" x 30" Diamond, 1/2" thick
Weight: 47 lbs. (21.5 kg)